

DOUBLE PLASTIC FILTERS (DISC&SCREEN) DD,DE

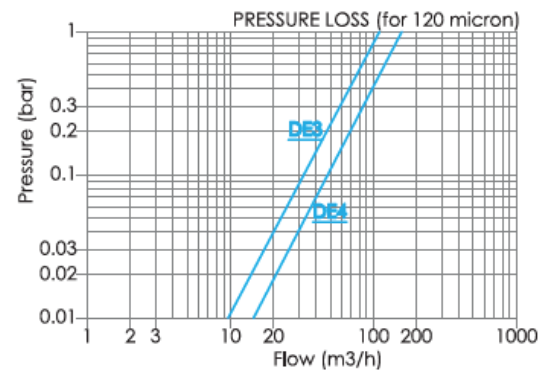
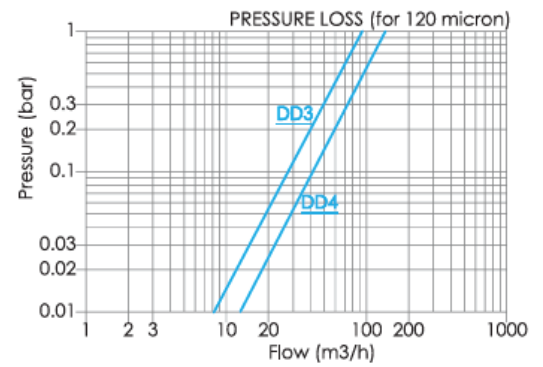
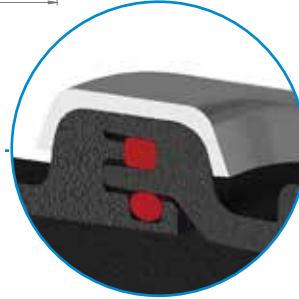
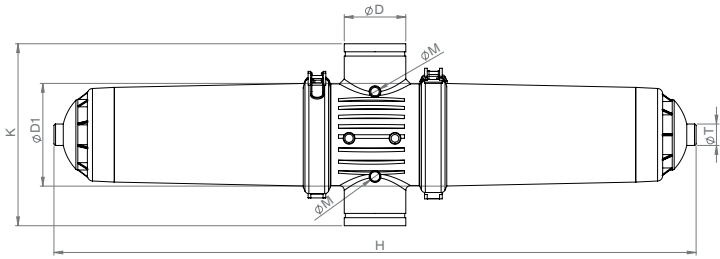

Code	D	M	T	D1	H	K	Flow	Filter Surface Area	Weight
	inch			mm			m ³ /h	cm ²	kg
DD3	3	1/4	3/4	190	960	340	50	2604	11,4
DD4	4	1/4	3/4	190	960	340	70	2604	11,6
DDS3	3	1/4	3/4	190	1200	340	60	3610	13,6
DDS4	4	1/4	3/4	190	1200	340	80	3610	13,8
DE3	3	1/4	3/4	190	960	340	50	2280	8,4
DE4	4	1/4	3/4	190	960	340	70	2280	8,6
DES3	3	1/4	3/4	190	1200	340	60	3040	9,8
DES4	4	1/4	3/4	190	1200	340	80	3040	10

General Characteristics

Body Material : Pa %30 Gfr

Cartridge Material: Pp (Disc) Pa (Screen Aisi 304 Cage Pa)

Maximum Workig Pressure : 8 Bar (116 Psi)

Maximum Working Temperature:60 C/ 140 F

The Filtration Degree: 20-50-100-125 Micron

Cartridge Of Filters:

D: Disc Cartridge

E:Screen Cartridge



6" DOUBLE PLASTIC FILTERS (DISC&SCREEN) DD,DE

6"



NEW
PRODUCT

Code	D	D1	H	K	M	T	Flow	Filter Surface Area	Weight
	inch	mm	mm	mm	inch	inch	m ³ /h	cm ²	kg
DD6	6	242	1655	420	1/4	1	180	6212	28
DE6	6	242	1655	420	1/4	1	180	5532	21
DDS	6	242	1655	420	1/4	1	160	5630	33

General Characteristics

Body Material : Pa %30 Gfr

Cartridge Material: Pp (Disc) Pa (Screen Aisi 304 Cage Pa)

Maximum Workig Pressure : 8 Bar (116 Psi)

Maximum Working Temperature:60 C/ 140 F

The Filtration Degree: 20-50-100-125 Micron

Cartridge Of Filters:

D: Disc Cartridge

E:Screen Cartridge

